



QUALITY • COMMITMENT • CONSISTENCY

Manufacturing Quality Products







## The Kapal Difference

At Kapal, we pride ourselves on delivering timely service, exceptional craftsmanship, and top-quality manufacturing of residential and commercial kitchen cabinets and countertops throughout the Texas Rio Grande Valley. Our wide selection of wood types, stone colors, finishes, and hardware allows our customers to personalize their spaces with ease. We believe that style goes beyond aesthetics, and we're dedicated to bringing each customer's vision to life.

Kapal's journey began in 2008 with our first 10,000-square-foot cabinetry production plant. By 2011, we had expanded to 20,000 square feet, and in 2014, we entered the granite and quartz industry, reaching a total of 40,000 square feet of manufacturing facilities. In 2017, we introduced a state-of-the-art facility adjacent to our cabinetry plant, specializing in the fabrication of granite, quartz, and solid surface countertops—particularly for multifamily apartments and the hospitality industry.

In 2018, we moved our cabinetry plant to an 80,000-square-foot facility in Weslaco, TX. In 2024, we added an additional 10,000 square feet to the Weslaco facility for the storage of finished products, bringing our total manufacturing and storage space to an impressive 150,000 square feet. This growth enables us to better serve our customers with precision and efficiency.

We are proud to be among the first turnkey manufacturers to offer both cabinets and countertops with short lead times. With Kapal, you can trust that your project is in capable hands, managed by experts dedicated to professionalism and superior craftsmanship from conception to completion.



# Table of Contents

Multifamily Apartments	Page 2-3
Hospitality	Page 4-5
Residential Kitchens	Page 6-7
Countertops	Page 8
Cut to size Countertops	Page 9
Sinks	Page 10
Closets	Page 11-12
3D & Textured Panels	Page 13-14
Installation	Page 15-16
Unfinished Cabinets for Kitchen and Bath	Page 17-18
Standard Engineering of Kitchen Cabinets	Page 19-20
Why Purchase Domestic?	Page 21
Kapal Added Value	Page 22
Credit Terms	Page 23

## **Vision:**

Be the best in the industry by continuously setting and meeting new goals.

## **Mission:**

With research and preparation, we plan to deliver high quality products and supplies to our customers, working diligently to meet their needs and desires.

## **Core Values:**

Treat customers with uttermost respect, honesty and humbleness, making their happiness our priority.





# Multifamily Apartments

## Offering Cabinetry & Countertop Manufacturing in the USA

We manufacture cabinetry and countertops in-house, ensuring high-quality products with fast lead times, including professional installation.

### Traditional & Contemporary Style: Dado or Dowel construction

- Plywood White Shaker full overlay
- Face frame standard overlay (Dado Construction)
- Frameless full overlay (Dado or Dowel construction)

### Cabinet Case:

- Faceframe: 1/2" Particle Board with melamine or 1/2" Plywood UV coated
- Frameless: 5/8" or 3/4" Particle Board with melamine or 5/8" or 3/4" Plywood UV coated

### Drawers:

- Dado construction
- UV coated, build in 1/2" Russian Birch or Birch plywood
- Core hide with edgebanding

### Doors:

- Laminated TFL & HPL
- RTF (Rigid Thermofoil)
- Framed solid wood

### Hardware:

- Full extension slides
- Soft close

### Countertops:

- Quartz
- Granite
- Postformed HPL
- Solid Surface
- Thinscape

### Kitchen and Bath Sinks:

- Stainless Steel
- Cultured Marble
- Porcelain under and top mount

### Last Projects Developed:

Santal Luxury Apartments	Austin, Tx	370 Units
Avanti East Apartments	Edinburg, Tx	108 Units
Jackson Place Apartments	Pharr, Tx	288 Units
Ambrosio Subdivision	Pflugerville, Tx	370 Units
Santa Anna Apartment Homes	Weslaco, Tx	156 Units



# Framed Doors

**Wood Species:** Poplar, German Beech, and Maple



## Slab Doors

- Particle Board or MDF core with wood veneer
- Particle Board or MDF core with Melamine
- (TFL) Entry Level 1

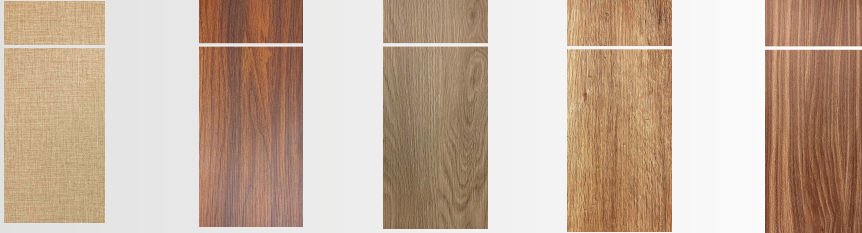

Available In Stock! (Other Colors are per order)

## Particle Board or MDF Core With Melamine (FFC)

### Wilsonart Lujo Collection



**Avondale Ash**  
Finish:  
Ridgewood

**Monteverdi**  
Finish:  
Timbergrain

**Daintree**  
Finish:  
Ridgewood

**Crystal River Oak**  
Finish:  
Ridgewood

**Black Hills Oak**  
Finish:  
Ridgewood

**Coronado Oak**  
Finish:  
Gloss Line

**Neowalnut**  
Finish:  
Gloss Line

**Anderson Cherry**  
Finish:  
Silken Wood

Available In Stock! (Other Colors are per order)

## Rigid Thermofoil Doors



Slab

Shaker

Shaker  
Wide

# Hospitality

- Hotels
- Clinics

## Clinics





# Hotels



## Last Hotels Projects Developed:

Element Hotel	Katy, Tx
Holiday Inn	San Marcos, Tx
Holiday Inn Express & Suites	Brenham, Tx
La Quinta Inn & Suites	McAllen, Tx
Fairfield Inn & Suites	Brownsville, Tx



# Residential Kitchens

- Traditional
- Contemporary
- Modern



# Outdoor Kitchens

- Waterproof HDPE cabinetry
- Granite and DEKTON countertops
- \*Coyote Outdoor appliances



\*you can provide your own brand for the appliances.





# Countertops

- Hotels
- Multifamily
- Hospitality
- Cut to size





# Cut to size

**Quartz, Granite, Dekton, and Marble** are fabricated in our state-of-the-art facility, expertly cut to size and polished to perfection.

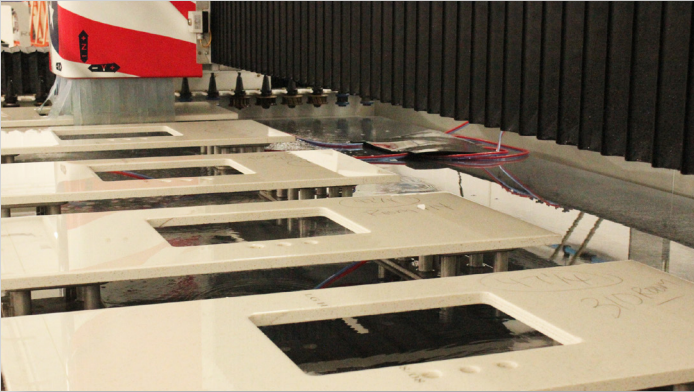
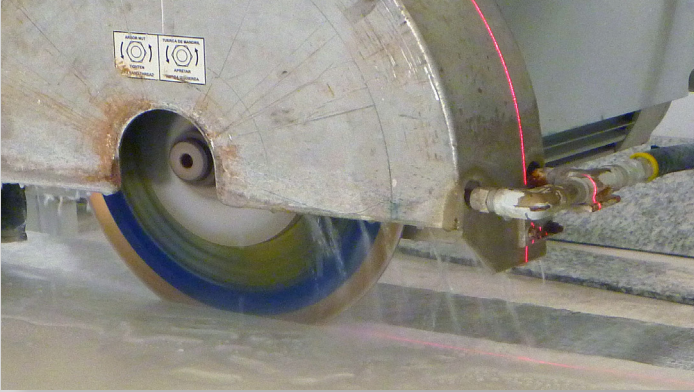

# Sinks

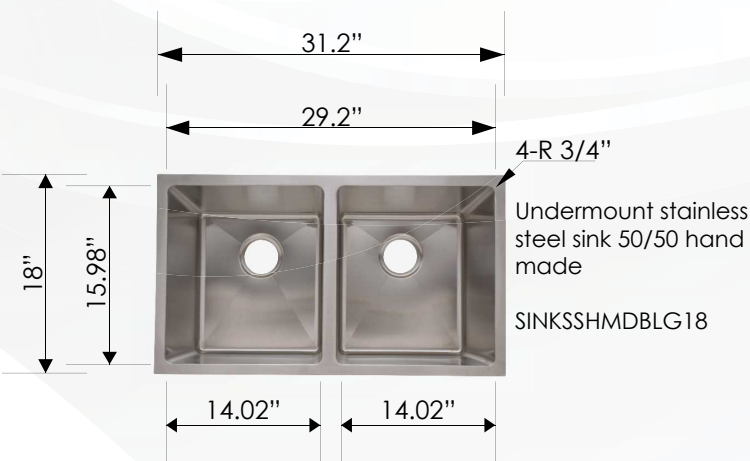
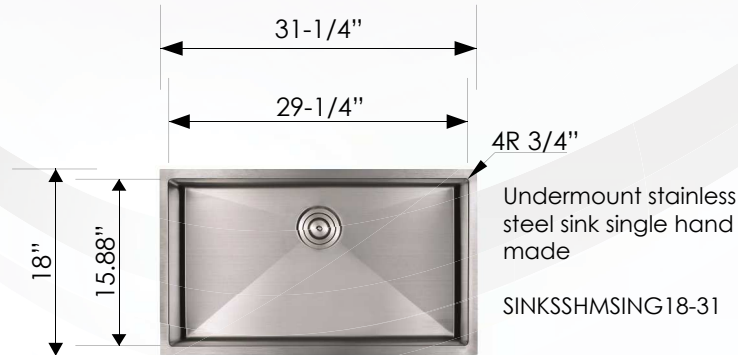
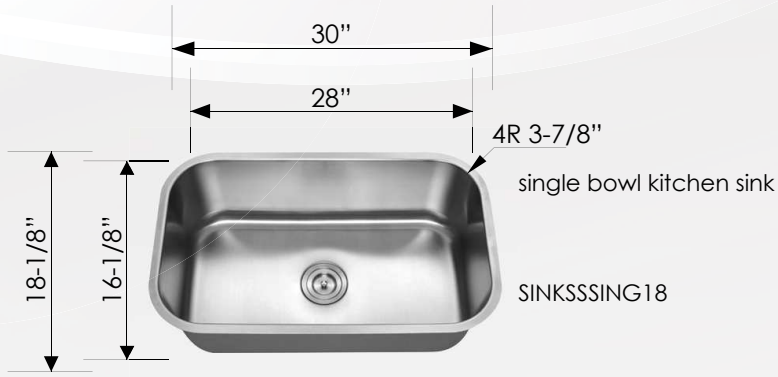



# Closets

- Laminated material
- Ready assembled
- No professional Installation required



**Dark  
Ash**



**Linen  
Texture**



**Siberian  
Larch**



**Brown  
Walnut**



Special Order





# 3D & Textured Panels

A Textured panel installed in the right place enhance the beauty of every detail surrounding it.

- Special designs
- Versatile & adaptable panels
- Apply your own finish

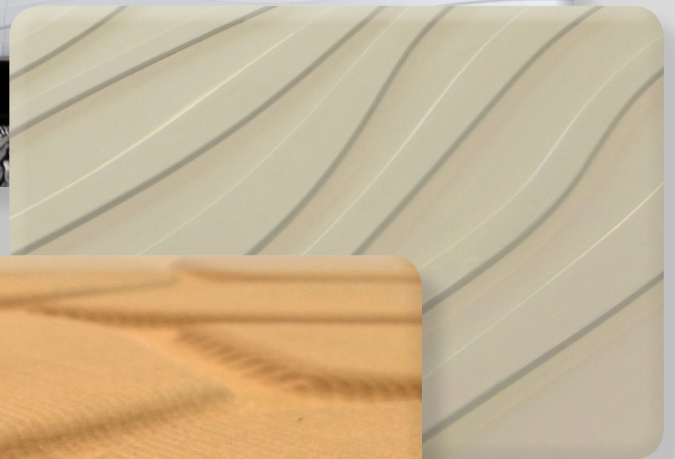





# Installation Services

- Professional cabinetry installation
- Professional countertops installation
- Own delivery fleet
- Serving all across Texas







# Unfinished Cabinetry for Kitchens & Baths



## Slab MDF



## Slab MDF (With Groove)



## Slab MDF (Shake Style)



## Poplar Shaker Doors 5 Pc



## German Beech Shaker Doors 5 Pc





# Standard Engineering of Kitchen Cabinets Face Frame



## Kitchens Cabinets Side View and Measurements

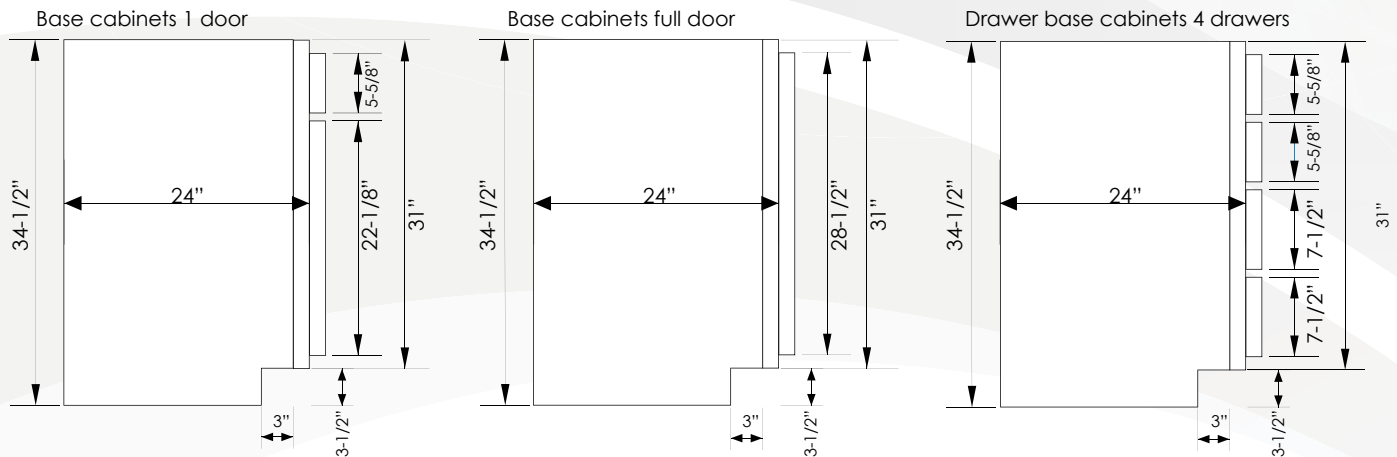

# Standard Engineering of Kitchen Base Cabinets Frameless

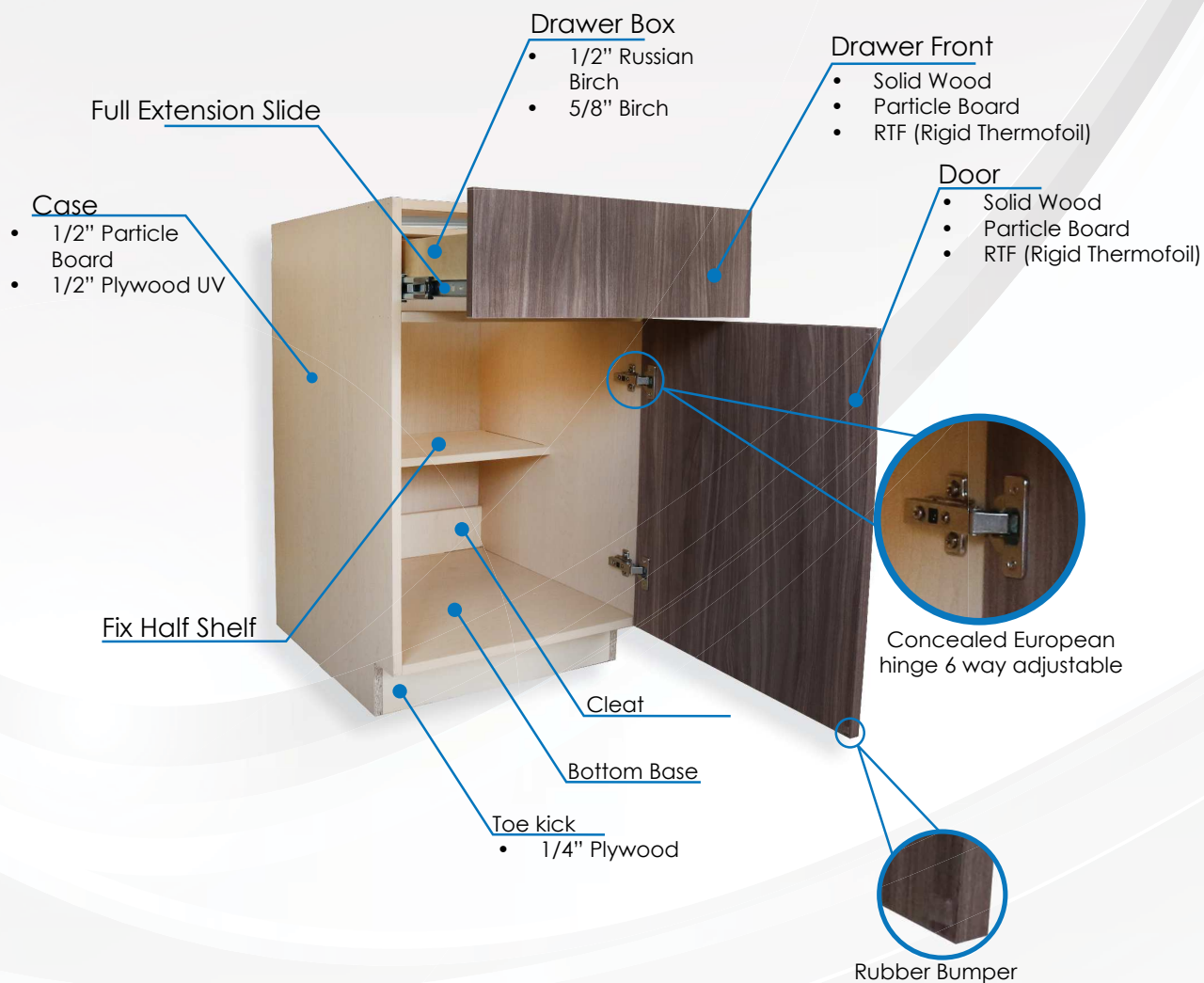

Note: (A) Width dimensions can be customized on large projects.



# Why Purchase Domestic?

Let's Eliminate Hidden Costs!

- **Faster Lead Times:** Get your materials quicker with no delays.
- **Better Payment Terms:** Enjoy more flexible payment options.
- **Flexibility with Dimension Changes:** Easily accommodate any adjustments needed.
- **No Inventory Sitting at Job Site:** Order when you're ready to install—no storage costs.
- **Change Order Friendly:** We can accommodate changes during the project without hassle.
- **No Leftover Material:** Order exactly what you need, reducing waste and extra costs.
- **Faster Replacements/Reworks:** Quick turnaround times for any issues.

If these advantages don't translate into savings for your project, it's better to

**"Keep the money at home."**

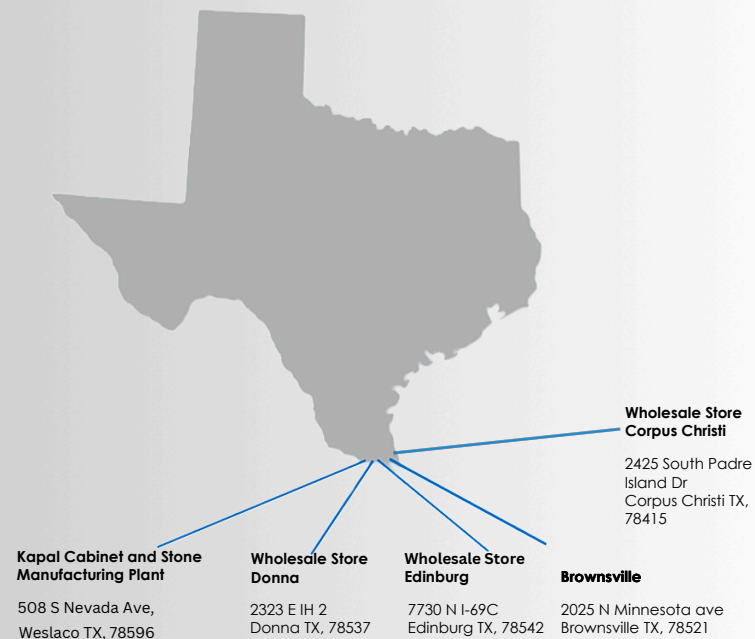

# Kapal Added Value

- **Corner Protection Packaging:** All cabinets come securely packaged with corner protection to prevent damage during transport. **(A)**
- **Complete Installation Accessories Included:** Every order includes all necessary accessories for installation—shims, screws, cap screws, silicone, and touch-up crayons. **(B)**
- **Dust-Free Installation:** Microwave exhaust ducts and island electrical receptacle cutouts are pre-made in the factory, eliminating dust and mess at the job site. **(C)**
- **Pre-Drilled Cabinets:** All cabinets are pre-drilled for easy attachment to adjacent units, ensuring faster installation and consistent screw placement. **(D)**
- **Standardized Cabinet Backing:** All cabinet backs are uniform in thickness (1/2", 5/8", or 3/4"), ensuring consistency across all units. **(E)**
- **Plywood Drawer Bottoms:** Drawer bottoms are made from high-quality plywood in 1/2", 5/8", or 3/4" thicknesses. **(E)**
- **High-Quality Boards:** We use either melamine or plywood for boards, eliminating the use of wrap paper (unless specified). **(F)**
- **Property Identification:** Each cabinet is clearly labeled with its position in the room and building, along with the job name for easy identification. **(G)**
- **Barcode Scanning:** Shipments are loaded and scanned with barcodes to ensure complete and accurate deliveries. **(G)**
- **No Cutting on Site:** No Quartz or Granite cutting is done at the job site, ensuring no dust or mess at your location.

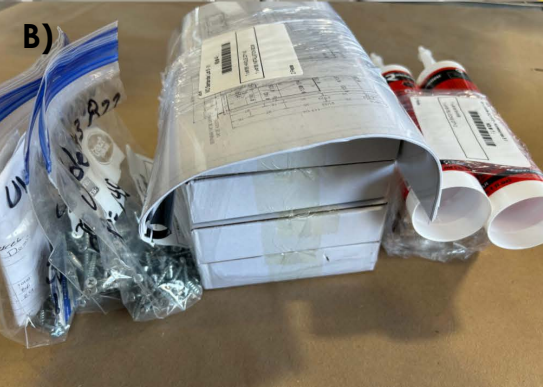



# Credit Terms

**Kapal offers credit based on the purchase history of the past 24 months.**

- Credit Amount: Customers are eligible for credit equal to 5% of the sales invoices from the past 24 months, with terms of Net 30.
- Credit Usage: The credit can be applied as a down payment, retainage, or final payment, with the same Net 30 terms.
- Payments:
  - For Common Material Minimum Downpayment of 30% at Initial.
  - For Special Material (Cannot be used w/ another customer): Minimum Downpayment of 50% at Initial.
  - Rest of Payment of Merchandise Value before Delivery for Each Shipment: The product will be manufactured in advance, one or two weeks before the delivery date requested by the customer. However, customers cannot receive the merchandise by the time requested by them, the product will be held for 30 days, however payment must be submitted for the partial of the manufactured items requested with proof of merchandise manufacture if needed.





QUALITY • COMMITMENT • CONSISTENCY



**Our Products and Services:**

- Residential
- Hospitality
- Multifamily
- Hotels
- Installation
- Cut to Size
- Closets
- 3D & Textured Panels

**Our Locations:**

**Wholesale Store  
Donna**  
2505 E IH 2  
Donna TX, 78537

**Wholesale Store  
Edinburg**  
7730 N I-69C  
Edinburg TX, 78542

**Wholesale Store  
Brownsville**  
2025 N Minnesota  
ave Brownsville TX,  
78521

**Wholesale Store  
Corpus Christi**  
2425 South Padre  
Island Dr Corpus Christi  
TX, 78415

**Kapal Cabinet and Stone  
Manufacturing Plant**  
508 S Nevada Ave Weslaco  
TX, 78596

**Kapal Industries**

**November 2024**